

GATEWAY PEDESTRIAN BRIDGE AND TRAIL

COLLEGE PARK, GEORGIA

The City of College Park needed to design and construct a new pathway and gateway bridge to connect the Georgia International Convention Center and People Mover to downtown College Park. The project was funded through a \$250,000 grant from the Atlanta Regional Commission Transportation Alternatives Program (TAP) and the City of College Park.

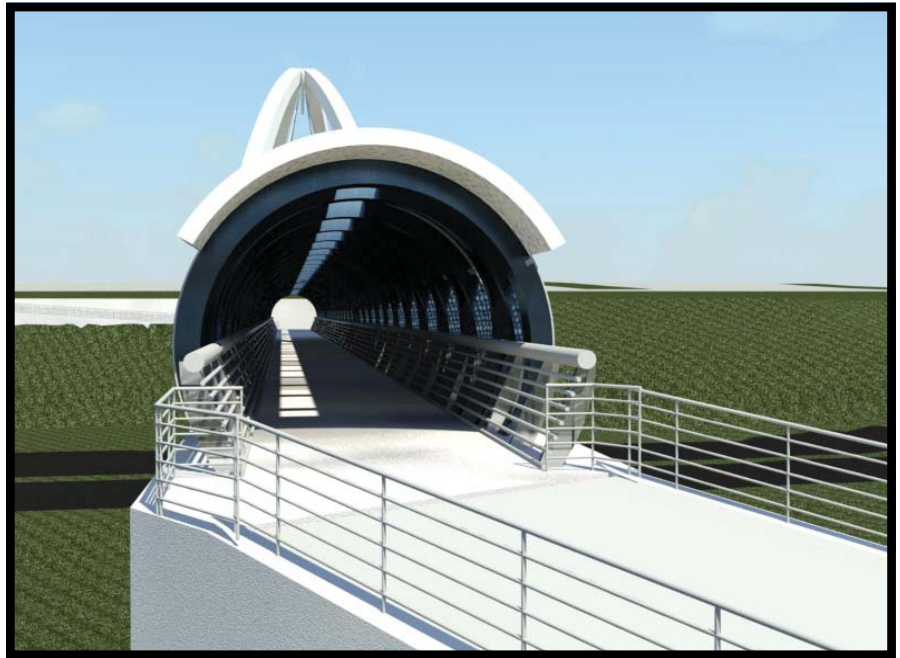

Prime prepared concept design, survey database, and categorical exclusion for the

construction of this new 1.08-mile pedestrian bridge and trail. Design was per the Georgia Department of Transportation (GDOT) Plan Development Process.

Key elements included:

- Bridge and trail design to meet GDOT and City of College Park design requirements
- Surveying (database preparation and right-of-way, property lines, easements and plats for bridge/trail)
- TAP Compliance
- Landscape and trail safety
- Signage and markers (to engage users and tell the story of College Park's history, particularly around the airport)

